

powietrze nigdy nie było tak eleganckie

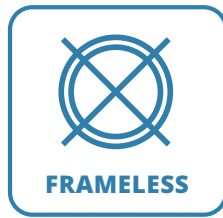

SIDE





Frameless, side-mounted diffusers can be used not only for recuperation systems, but also for air conditioning systems. Their unique design ensures air diffusion under the partitions into which they are mounted. The cap on the facade can be puttied and painted in the same way as the entire diffuser enclosure. Air flow can be restricted in any direction. Facade caps can be chosen in round, square or individual shape. The distance of the cap from the wall is adjustable, so this parameter can be changed if needed.

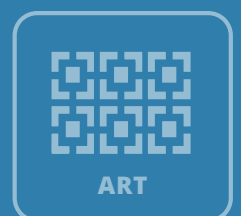
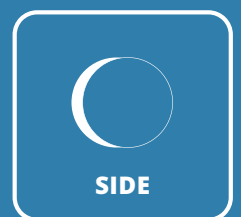
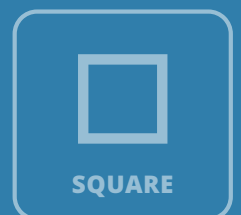
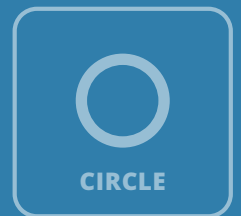
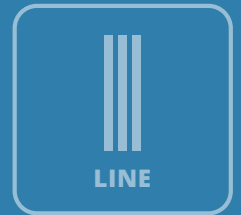

Installation
Video instructions:
 YouTube

SIDE 100/125

WALL DIFFUSER



SIDE ROUND



SIDE SQUARE

100/125 mm
DIAMETER OF COUPLING SLEEVE

2.735 kg
WEIGHT WITHOUT PACKAGING (NET)

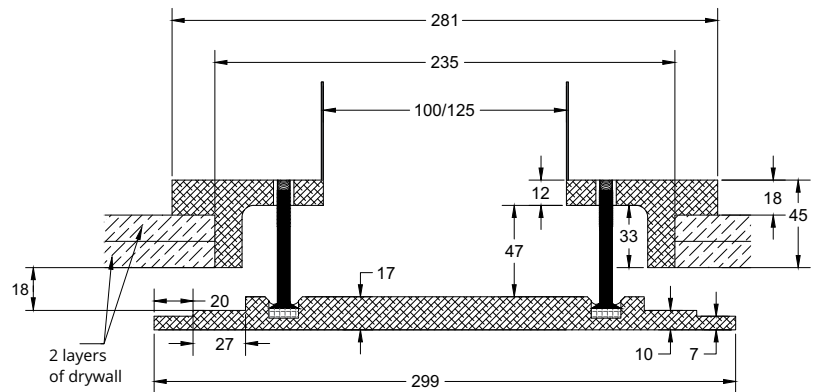
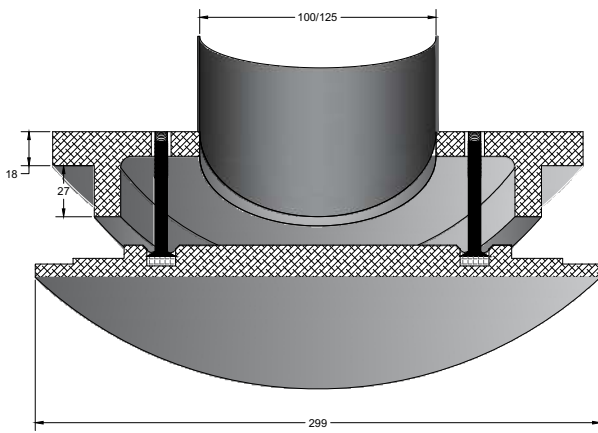

Airborne noise and resistance, 1 m.

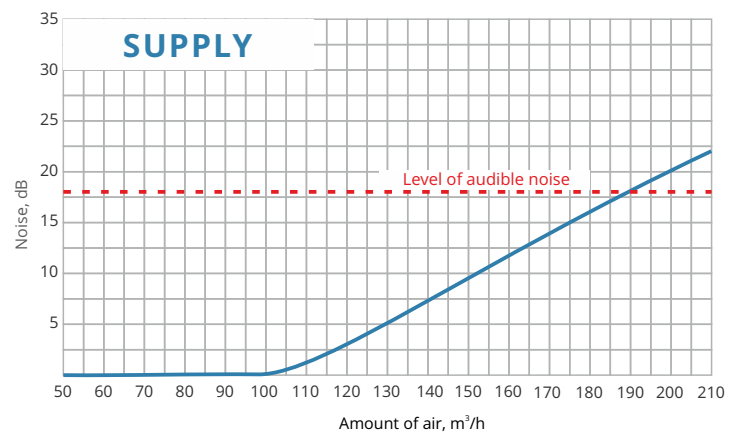
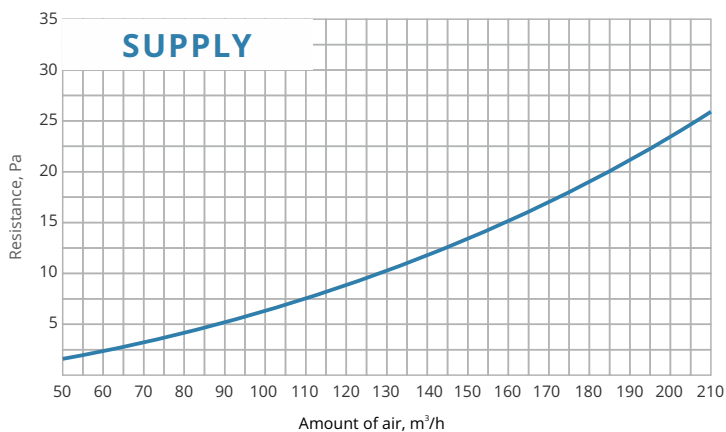

Due to its unique design, this diffuser ensures air diffusion in a horizontal plane when installed in the ceiling or in a vertical plane when installed in a wall. This is why this diffuser can be mounted above the seating, desk without causing discomfort to the occupant.

SENSIBLE AIRFLOW

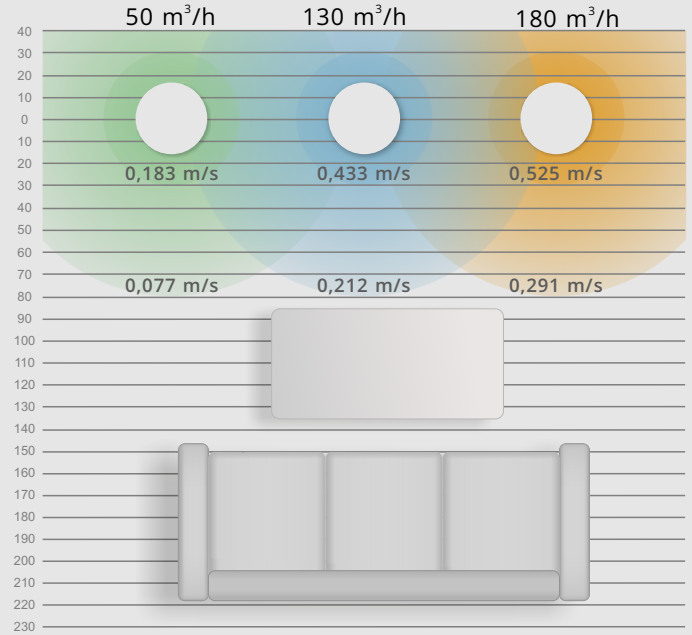

Airflow perceptible with the Side diffuser in the ceiling (top view)

Air velocity at distance from diffuser

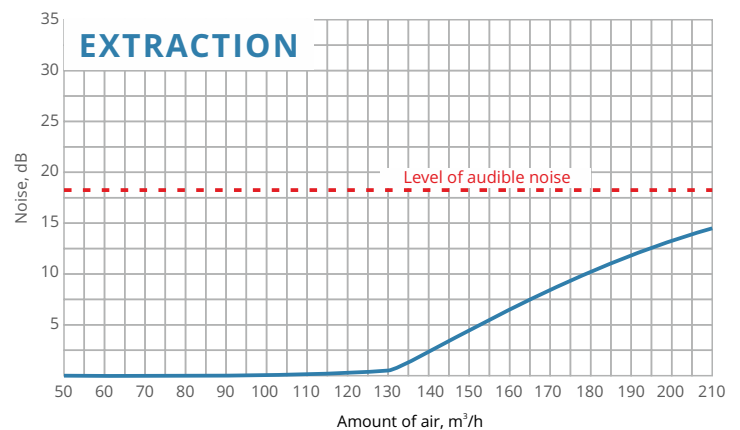
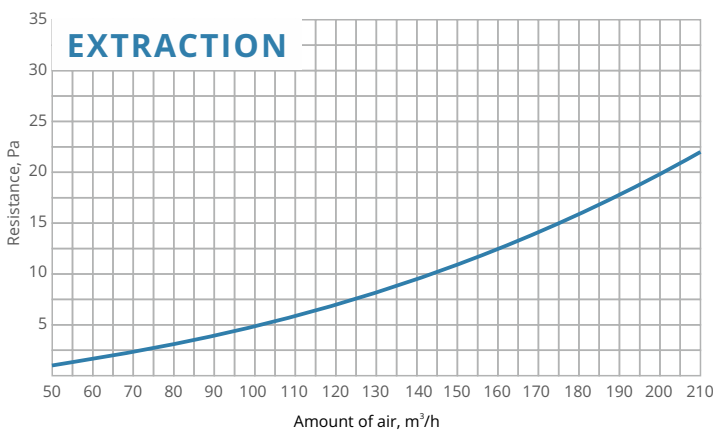
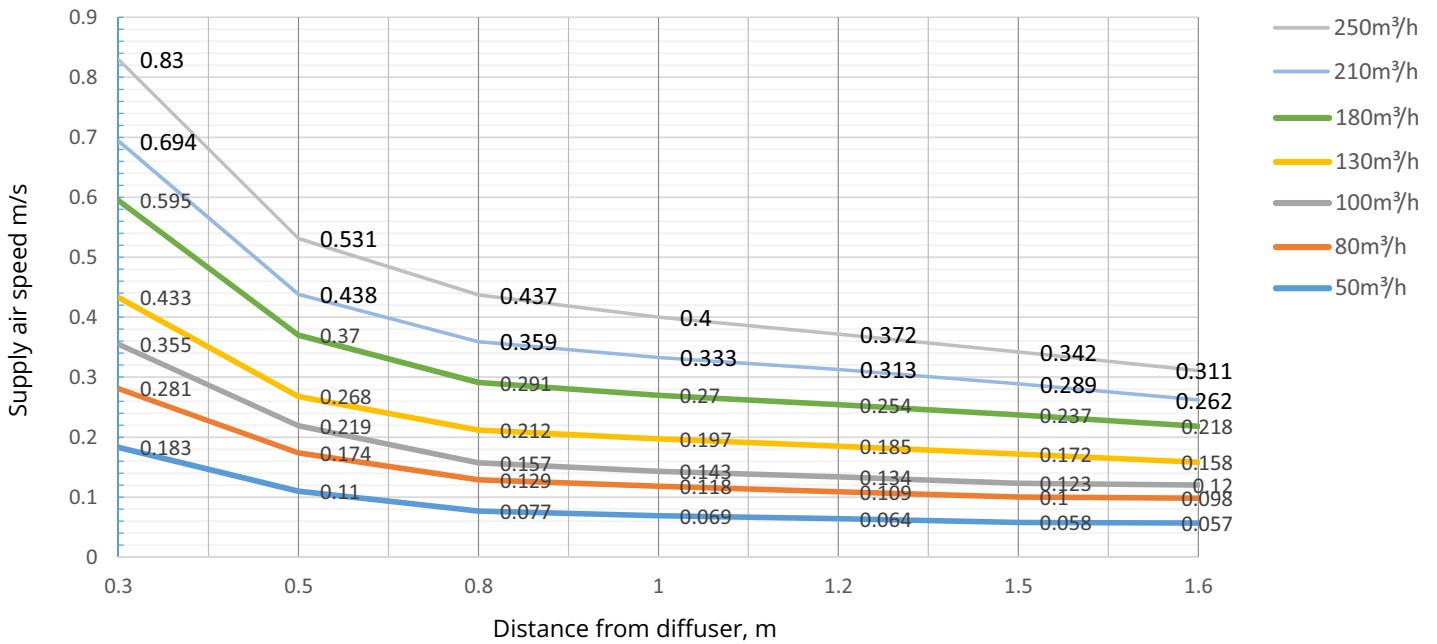

SIDE 160

WALL DIFFUSER

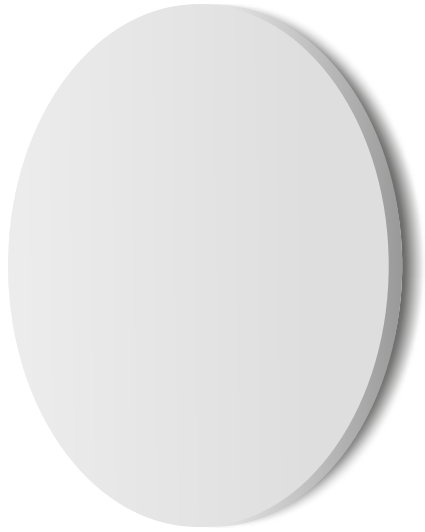

SIDE ROUND



SIDE SQUARE

160 mm
DIAMETER OF COUPLING SLEEVE

3.968 kg
WEIGHT WITHOUT PACKAGING (NET)

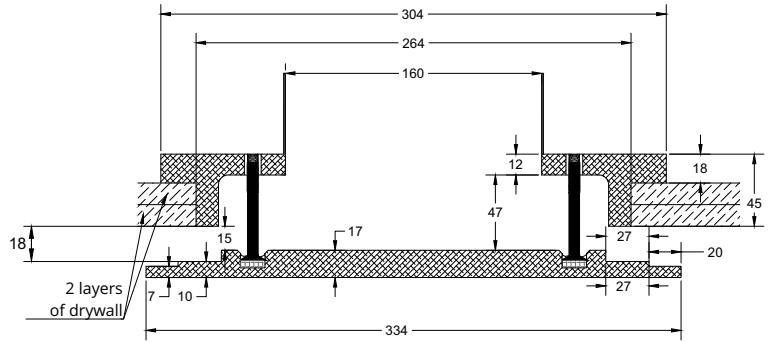
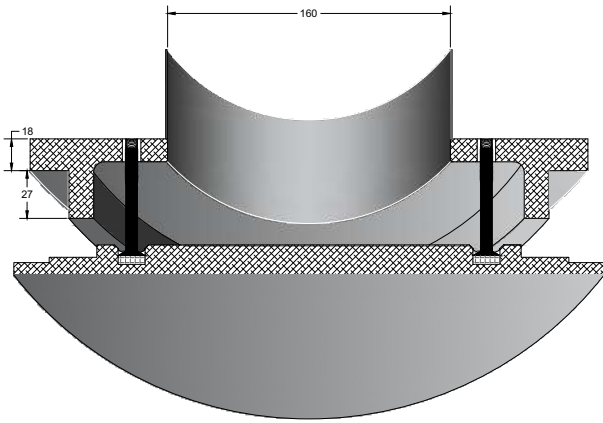

Airborne noise and resistance, 1 m.

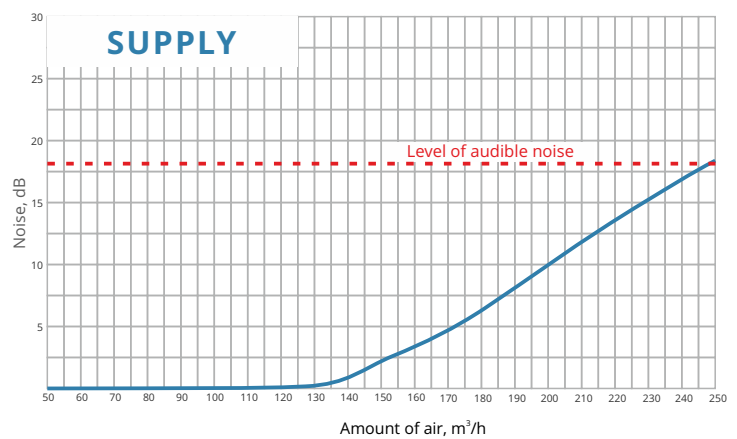
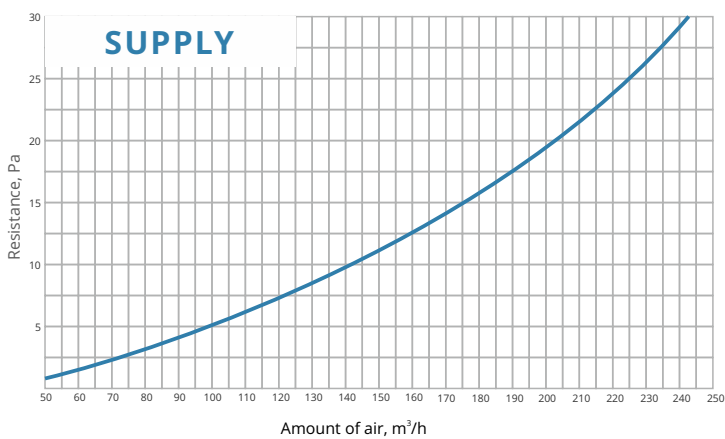

This is a medium-sized Side diffuser. Ideal for both ventilation and air conditioning systems. The diffuser is ideal for supplying and extracting air from the premises. Due to its unique design it can be mounted above seating, desks, etc.

SENSIBLE AIRFLOW

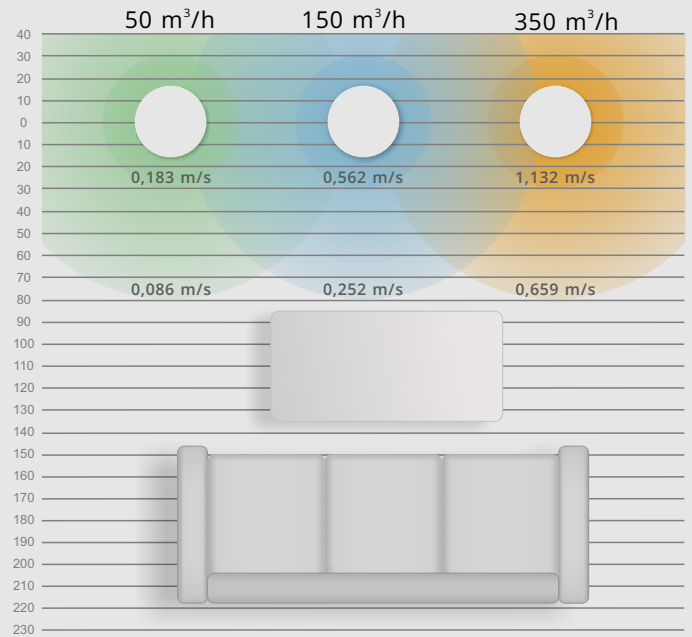

Airflow perceptible with the Side diffuser in the ceiling (top view)

Air velocity at distance from diffuser

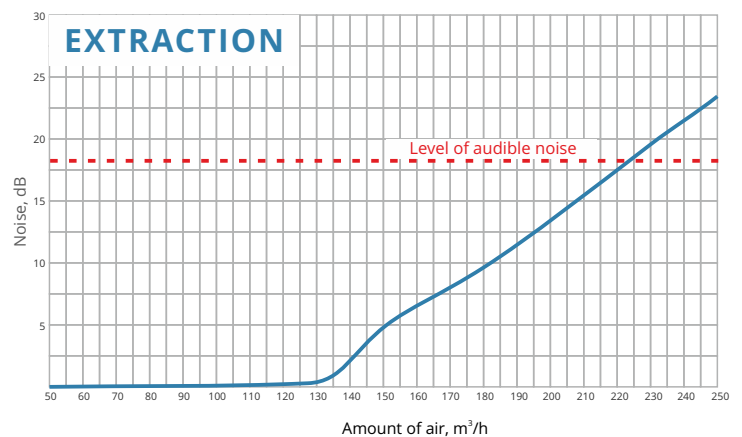
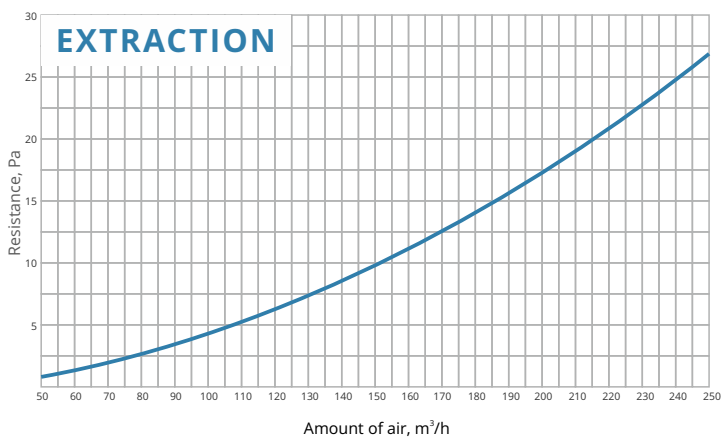
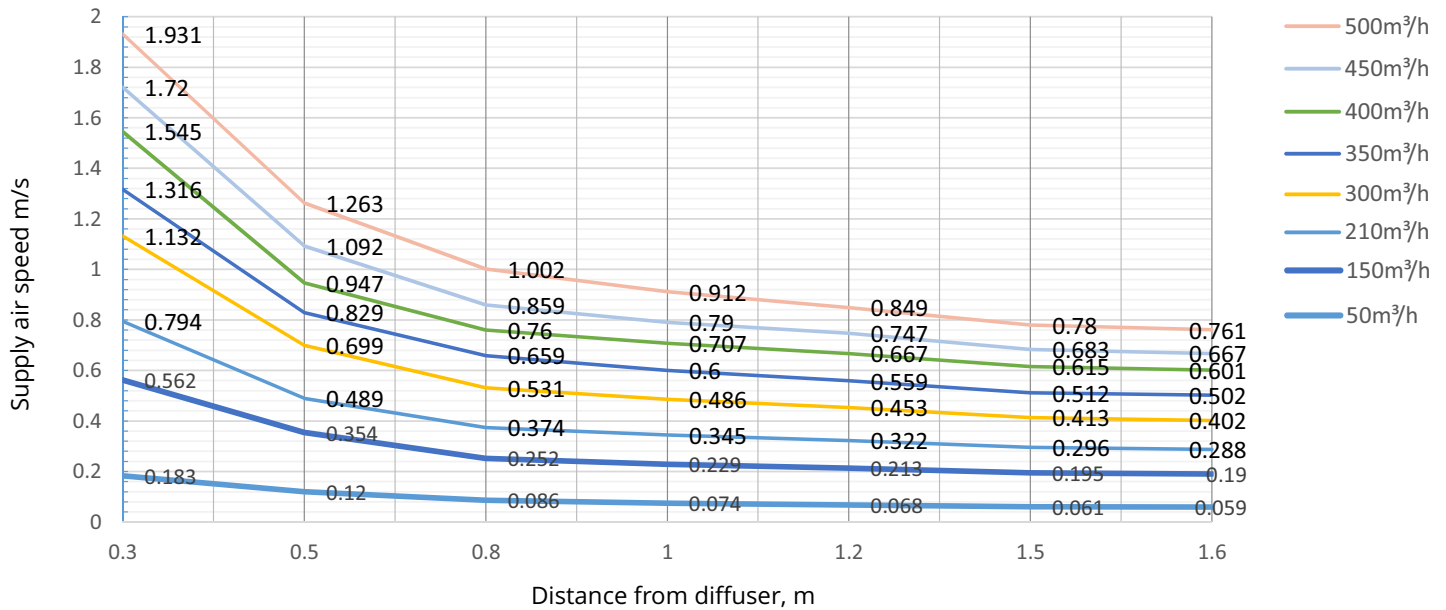

SIDE 250

WALL DIFFUSER



SIDE ROUND



SIDE SQUARE

250 mm
DIAMETER OF COUPLING SLEEVE

4.8 kg
ROUND MODEL WEIGHT WITHOUT
PACKAGING (NET)

6.2 kg
SQUARE MODEL WEIGHT WITHOUT
PACKAGING (NET)

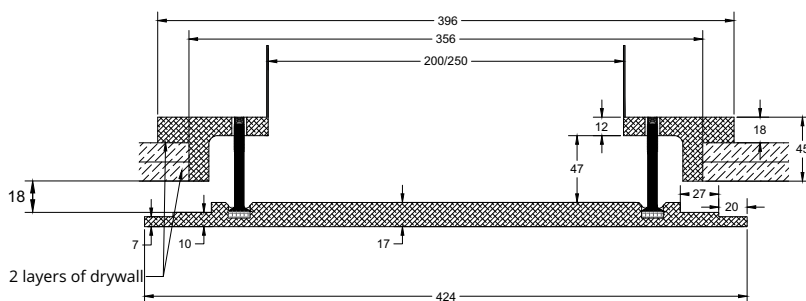
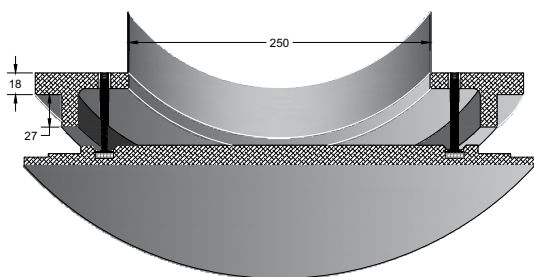

Airborne noise and resistance, 1 m.

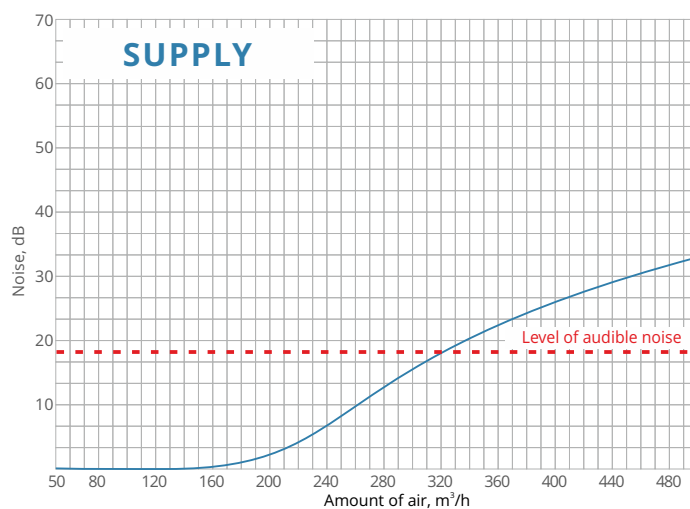
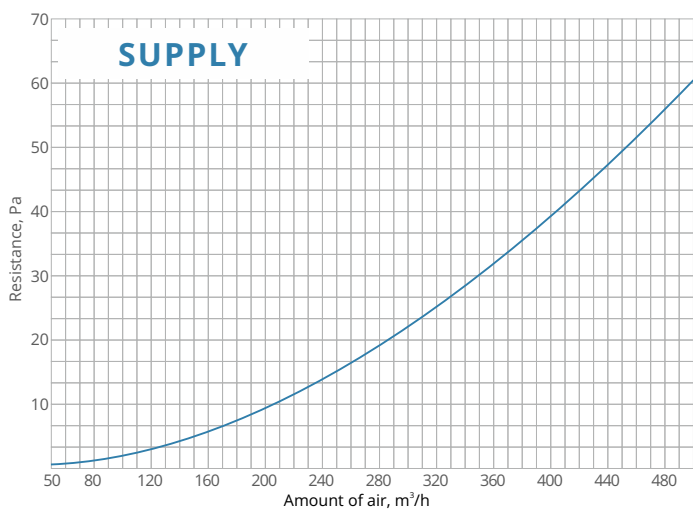

It is the largest Side diffuser. Ideal for both ventilation and air conditioning systems. The diffuser is ideal for supplying and extracting air from the premises. Due to its unique construction it can be mounted above workstations.

SENSIBLE AIRFLOW

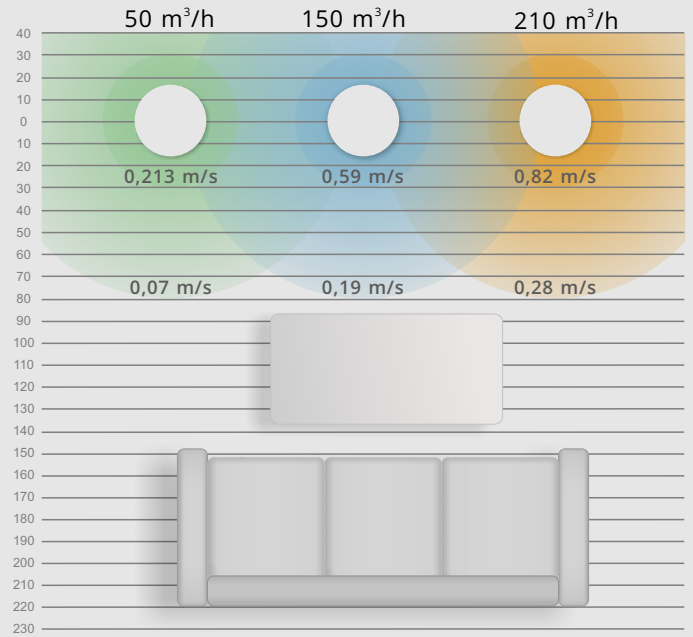

Airflow perceptible with the Side diffuser in the ceiling (top view)

Air velocity at distance from diffuser

